

# Instructions

## Lampshade Making Kits



### What is in the box:

- 1 x Self-Adhesive Stick-it Panel
- 1 x Painted Utility Ring
- 1 x Painted Metal Ring
- 1 x Roll of Double-Sided Tesa Tape
- 1 x Finishing Tool

### Before you get started you will need:

- Covering of choice
- Clean flat working area
- Sharp Knife or Scissors
- Seam Roller (not essential)

**Important info:** If your covering is directional, you need to think about which ring to place at the top or bottom panel. The utility ring needs to be placed at the bottom if you want to use it with a table lamp, for pendant use (ceiling fitting) the utility ring must be placed at the top. Please check this before you start rolling your lampshade.



Scan to view the video tutorial

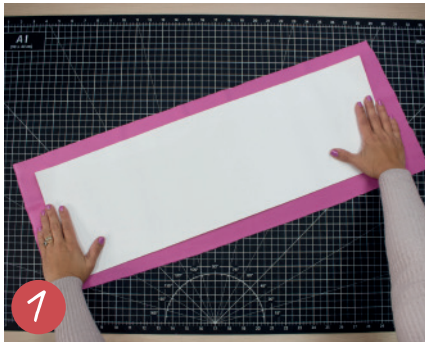

1 Cut down your covering to a workable size. Place face down and position the Stick-It panel on top.

**Tip** Iron your covering first to remove any creases.



2 When you're happy with placement peel back some of the release paper and stick down on your covering.

**Tip** Use a weight, such as a tin, to stop the panel from moving.



3 Smooth out from the middle and press the adhesive into the fabric firmly until all the release paper is removed. After you have inspected your panel for creases, the panel is now ready for trimming.

**Tip** If you feel a crease, peel back and try again.



4 Cut off surplus covering by running a sharp knife along the edges of the panel or use scissors.



5 Snap back and break the creased edges (kiss-cut) around the panel.

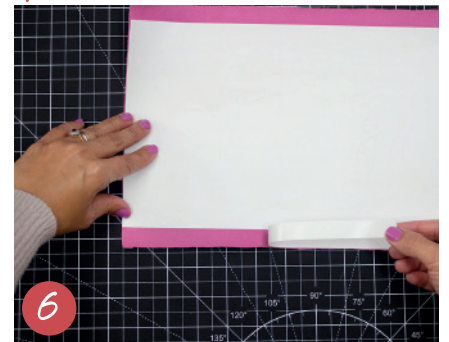

6 Carefully, to avoid fraying, remove the broken strips of the panel to leave your covering's edge.

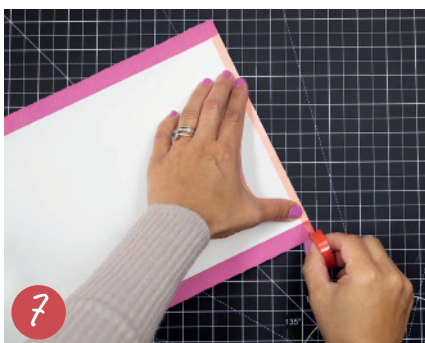

7 Apply double-sided Tesa tape to one side of the panel edge. This will be used to stick the seam.



8 Remove the release paper and your panel is now complete and ready for attaching to the rings.

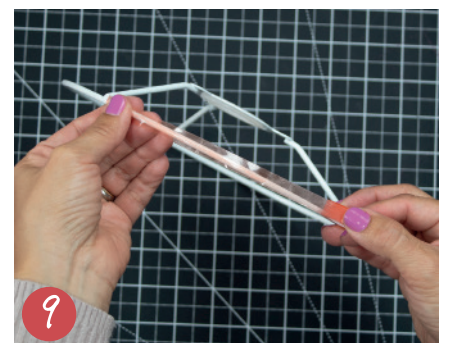

9 Apply the double-sided Tesa tape to the centre of the rings. Apply evenly and avoid creases.

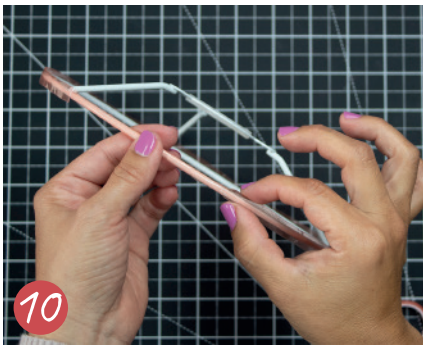

10

Press the tape down evenly and firmly onto the ring then remove the release paper.

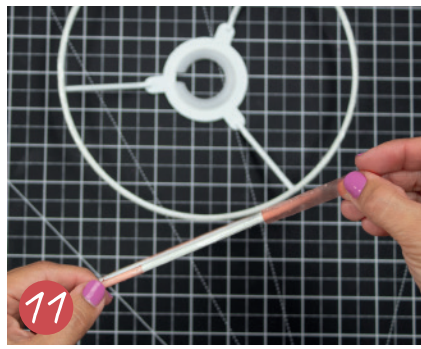

11

Repeat steps 10 & 11 for the final ring and you now have two sticky rings to fix to the panel.

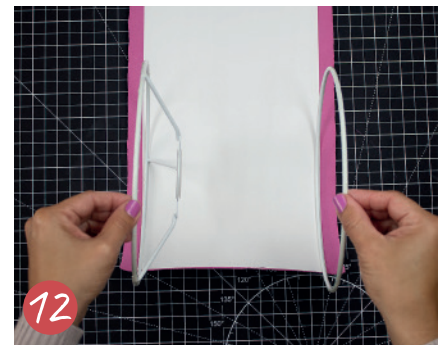

12

Place the rings on the panel edge (not on your covering) and start to roll towards the seam edge (step 8).

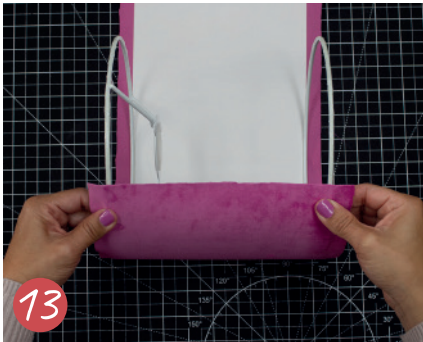

13

Keep in line with the panel edge at all times. If you run out of line go back and correct. As the lampshade starts to take shape, it will be easier to keep in line.



14

Now turn the lampshade around so you can roll towards you, keeping in line with the edge.

*Tip* Keep the rings in contact with the panel edge. Don't press the rings down hard onto the panel, as this makes it more difficult for you to tuck the covering behind when finishing.



15

When you get to the seam (the overlap), press the tape together from the centre out. The seam is now closed, do not apply any pressure here or you can dent the lampshade.



16

Place the lampshade with the seam on a hard surface and apply firm pressure, pressing the tape down.

*Tip* For best results use a seam roller.

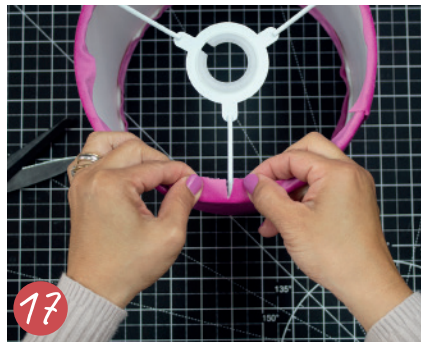

17

Snip the covering in line with the struts on the utility ring so that the covering can be folded under the rings.



18

Pinch the fabric, pull taut and fold down onto the sticky rings.



19

Use the finishing tool to push the fabric behind the rings. Push the tool between the gap and swipe around the circumference until you're happy with the finish.

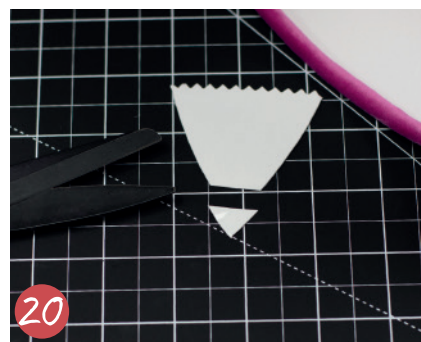

20

If the finishing tool bends, cut with scissors to refresh.



21

Enjoy your professionally finished lampshade!