

# Instructions

## Scalloped Lampshade



Scan to view  
the video tutorial

*Before you get started you will need:*

- 1 x Scalloped Ringset
- 1 x Scalloped Stick-it Self Adhesive Panel
- 1 x Roll of 9mm Double-Sided Tesa Tape
- 1 x Rolled Edge Tool
- Covering of your choice
- Clean flat working surface
- Scissors or sharp craft knife
- Seam Roller (optional)
- Pencil or Marker



1 Cut down your covering to a workable size. Place face down and position the Stick-It panel on top.

*Tip* Iron your covering first to remove any creases.



2 When you're happy with placement peel back some of the release paper and stick down on your covering.

*Tip* Use a weight, such as a tin, to stop the panel from moving.



3 Smoothing out from the middle, press the adhesive firmly onto the fabric pulling away until all the release paper is removed.



4 Check the fabric for creases. If you find one peel the fabric back and smooth it down again.

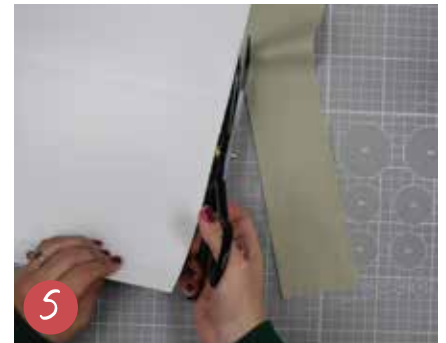

5 Cut away the surplus covering, with scissors, or a craft knife, using the edge of the panel as your guide.



6 Snap back the creased edges around the panel until the kiss-cut strip breaks.



7 Carefully remove the kiss-cut strips to avoid fraying.



8 Gently fold back the first crease so the fabric sides of the panel face each other. Repeat for all creases on the panel.



9 Apply double-sided Tesa tape to one side of the panel edge. This will be used to stick the seam.



10 On each frame, find the join in the white coating. Place over each other to ensure they match and mark with a pencil.



11 Apply the double-sided Tesa tape to the centre of the rings. Apply evenly all around and avoid creases.



Snip the tape on each side of the frame at each inverted corner, before pushing the tape around the frame. This helps the tape to adhere fully to the frame.



Press the Tesa tape down evenly and firmly onto the rings.

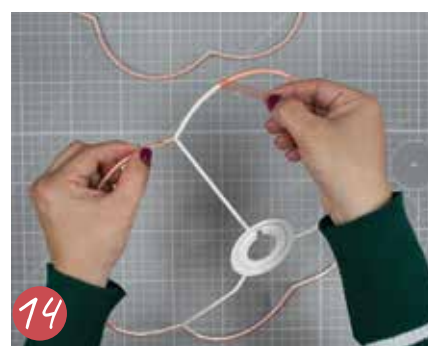

Remove the release paper. You'll now have two sticky rings.



Align the panel crease with the inverted scallop on the frame closest to the pencil mark, keeping the mark near the short panel edge. This helps the creases fit neatly into the ringset. Begin rolling toward the seam edge, lifting the creases into the scallop corners on both sides to evenly match the panel and ring.

**Tip** Keep the frame in line with the PVC edge throughout. If you deviate, move back and correct.



Remove the release paper from the seam edge. When you get to the overlap the adhesive will join the panel together.



Press the seam firmly together on the inside using a flat surface to rest on.

**Tip** For best results use a seam roller.



Snip the covering in line with the struts on the utility ring so that the covering can be folded under the rings.



Cut away a small square of fabric at the inside of the seam, to reduce any bulk.



Fold over the surplus covering all the way around on both sides, so it covers the rings.



Use the finishing tool to push the fabric behind the rings. Push the tool between the gap and swipe around the circumference until you're happy with the finish.



If the finishing tool bends, cut with scissors to refresh.

**Note**  
Your kit now includes a newly designed finishing tool that is compact and durable, engineered for superior performance and exceptional results every time.



Enjoy your professionally finished Scalloped Lampshade!